

**MİMARİ KATALOG**  
**ARCHITECTURAL CATALOGUE**

**Alüminyum Kapı Pencere ve Giydirme Cephe Sistemleri**  
Aluminium Window Doors and Facade Systems

**RESCARA**



**Rd155**



# MİMARİ KATALOG ARCHITECTURAL CATALOGUE

Alüminyum Kapı Pencere ve Giydirme Cephe Sistemleri  
Aluminium Window Doors and Facade Systems



Rescara Sistem Detayları  
Rescara System Details

# Rd55

PROFİLLER

PROFILES

01

02

03

04

05

06

07

08

09

10



KASA PROFİLLERİ  
FRAME PROFILES

# Rd55

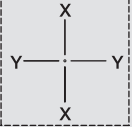

KOD / CODE	AĞIRLIK (kg/m) / WEIGHT	Jxx cm <sup>4</sup>	Jyy cm <sup>4</sup>	L m	
Rd55 F 01	1,373	25,243	38,509	6	
Rd55 F 02	1,500	25,765	48,453	6	

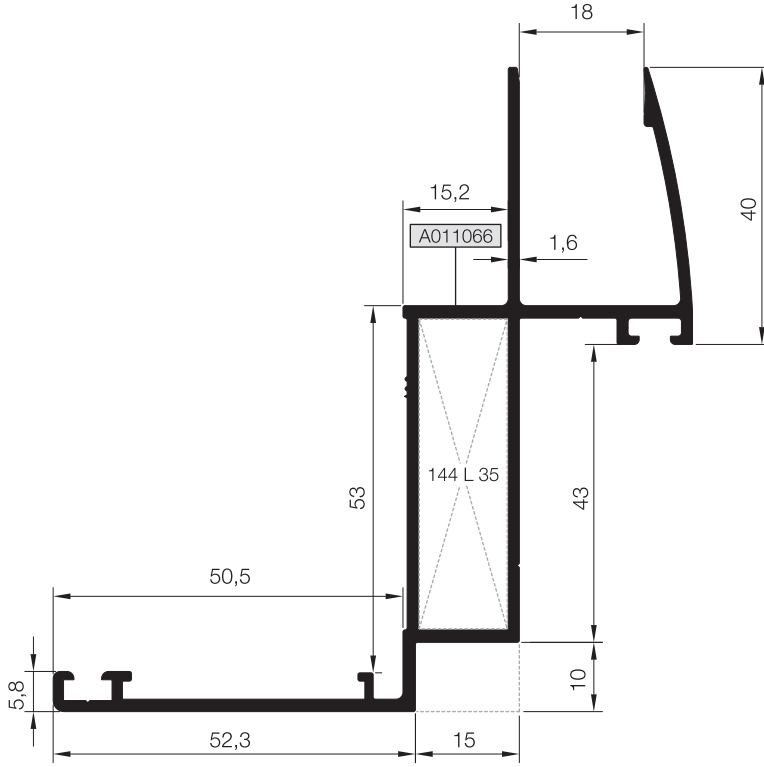
Rd55 F 01

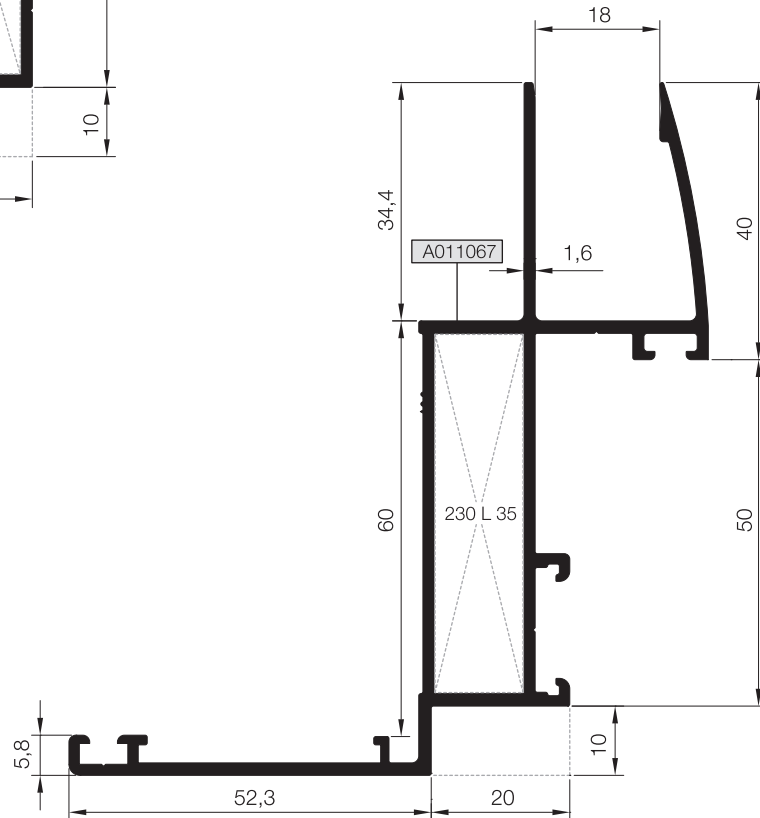

Rd55 F 02



Nr		 L m	KESİM ÖLÇÜSÜ CUTTING SIZE	 AKS. KODU ACS. CODE
Rd55 F 01	A011066	25 L 35 (A010076)	44,4 mm	144 L 35
Rd55 F 02	A011067	25 L 35 (A010076)	51,4 mm	230 L 35

KANAT VE ADAPTÖR PROFİLLERİ  
VENT AND ADAPTER PROFILES

# Rd55

KOD / CODE	AĞIRLIK (kg/m) / WEIGHT	Jxx cm <sup>4</sup>	Jyy cm <sup>4</sup>	L m
Rd55 V 02	0,688	1,267	4,539	6
Rd55 A 01	0,860	----	----	6
Rd55 A 02	0,977	----	----	6

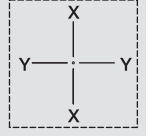

Rd55 V 02

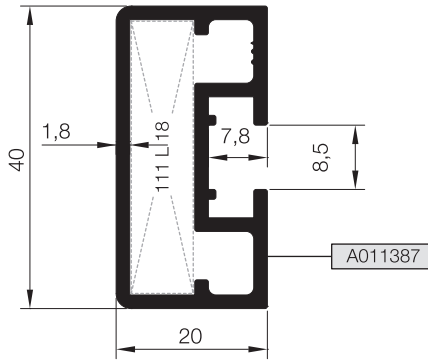

Rd55 A 01

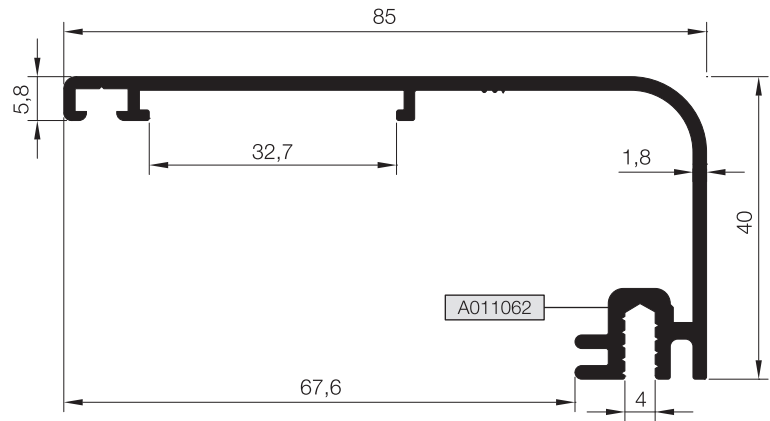

Rd55 A 02

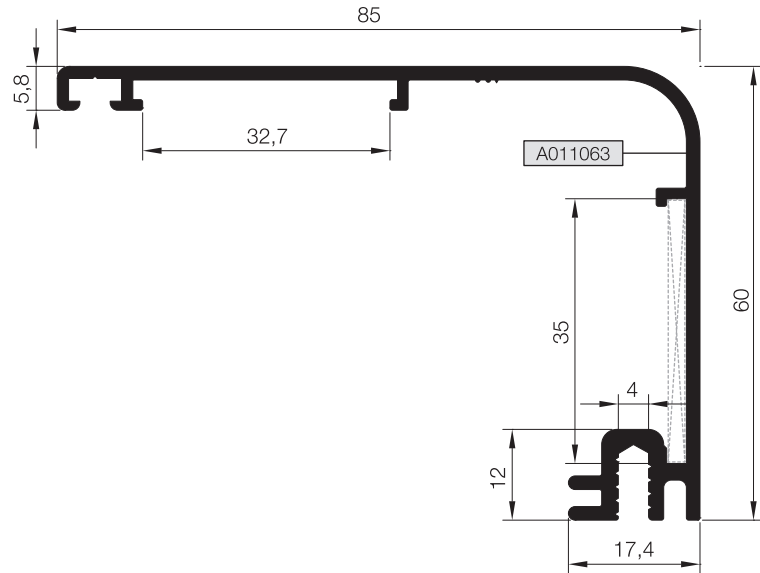

Nr		L m	KESİM ÖLÇÜSÜ CUTTING SIZE	AKS. KODU ACS. CODE
Rd55 V 02	A011387	25 L 18 (A002164)	35,9 mm	111 L 18
Rd55 A 02	A011063	25 L 71 (A011071)	34,06 mm	250 L 71

# ADAPTÖR PROFİLLERİ

## ADAPTER PROFILES

# Rd55

KOD / CODE	AĞIRLIK (kg/m) / WEIGHT	Jxx cm4	Jyy cm4	L m	
Rd55 A 03	1,154	----	----	6	
Rd55 A 04	1,376	----	----	6	
Rd55 A 05	0,771	----	----	6	

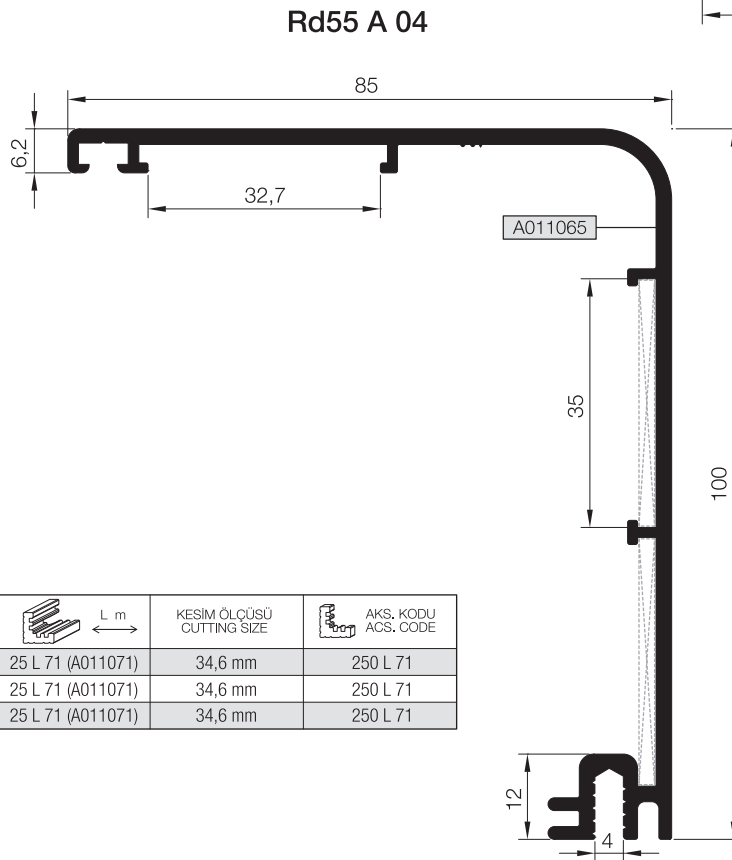
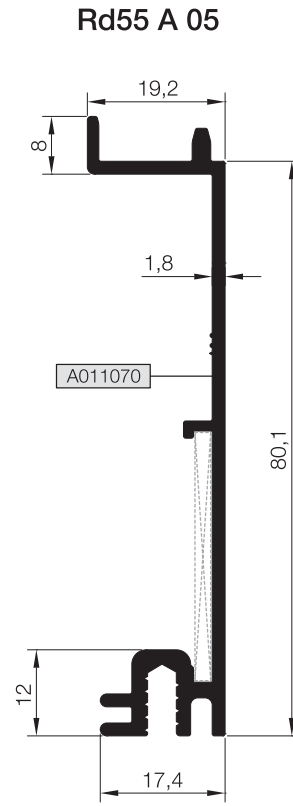
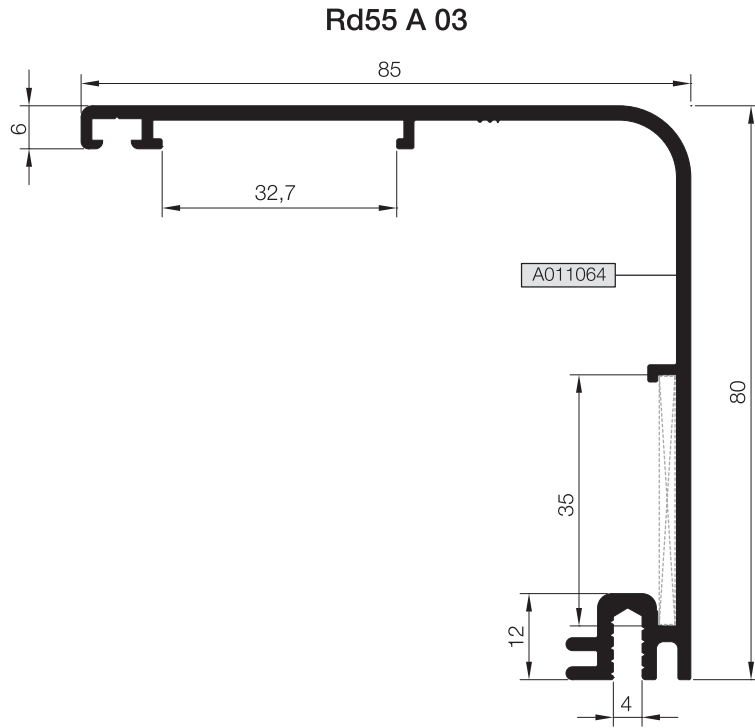

Nr		L m	KESİM ÖLÇÜSÜ CUTTING SIZE	AKS, KODU ACS. CODE
Rd55 A 03	A011064	25 L 71 (A011071)	34,6 mm	250 L 71
Rd55 A 04	A011065	25 L 71 (A011071)	34,6 mm	250 L 71
Rd55 A 05	A011070	25 L 71 (A011071)	34,6 mm	250 L 71

01

02

03

04

05

06

07

08

09



10

# KÖŞE TAKOZLARI

## CORNER CLEATS

# Rd55

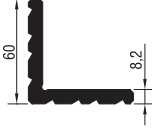
### TAKOZLAR (CLEATS)

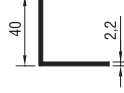
PROFİL KODU (PROFILE CODE)	25 L 18	25 L 35	25 L 71	
FABRİKA KODU (FACTORY CODE)	A002164	A010076	A011071	
AĞIRLIK (WEIGHT)	2,323 kg/m	4,192 kg/m	0,464 kg/m	
ÇİZİM (DRAWING)				

KÖŞE TAKOZLARI (CORNER CLEATS)				
Nr		 L m	KESİM ÖLÇÜSÜ CUTTING SIZE	AKS. KODU ACS. CODE
Rd55 F 01	A011066	25 L 35 (A010076)	44,4 mm	144 L 35
Rd55 F 02	A011067	25 L 35 (A010076)	51,4 mm	230 L 35
Rd55 V 02	A011387	25 L 18 (A002164)	35,9 mm	111 L 18
Rd55 A 02	A011063	25 L 71 (A011071)	34,6 mm	250 L 71
Rd55 A 03	A011064	25 L 71 (A011071)	34,6 mm	250 L 71
Rd55 A 04	A011065	25 L 71 (A011071)	34,6 mm	250 L 71
Rd55 A 05	A011070	25 L 71 (A011071)	34,6 mm	250 L 71

### STOKTA BULUNAN SİSTEM PROFİLLERİNİN LİSTESİ (LIST OF SYSTEM PROFILES IN STOCK)

Nr		MIN. SİPARİŞ MİKTARI MIN. ORDER QUANTITY
Rd55 V 02	A011387	75 kg
Rd55 V 04	A011065	75 kg
Rd55 A 05	A011070	75 kg

\* STOKTA BULUNMAYAN TÜM PROFİLLER İÇİN MİNİMUM SİPARİŞ MİKTARI 300'KG'DİR.  
MINIMUM ORDER QUANTITY FOR ALL THE PROFILES THAT ARE NOT IN STOCK IS 300 KG.



# MİMARİ KATALOG ARCHITECTURAL CATALOGUE

Alüminyum Kapı Pencere ve Giydirme Cephe Sistemleri  
Aluminium Window Doors and Facade Systems



Rescara Sistem Detayları  
Rescara System Details

# Rd55

DETAYLAR

DETAILS

01

02

03

04

05

06

07

08

09

10



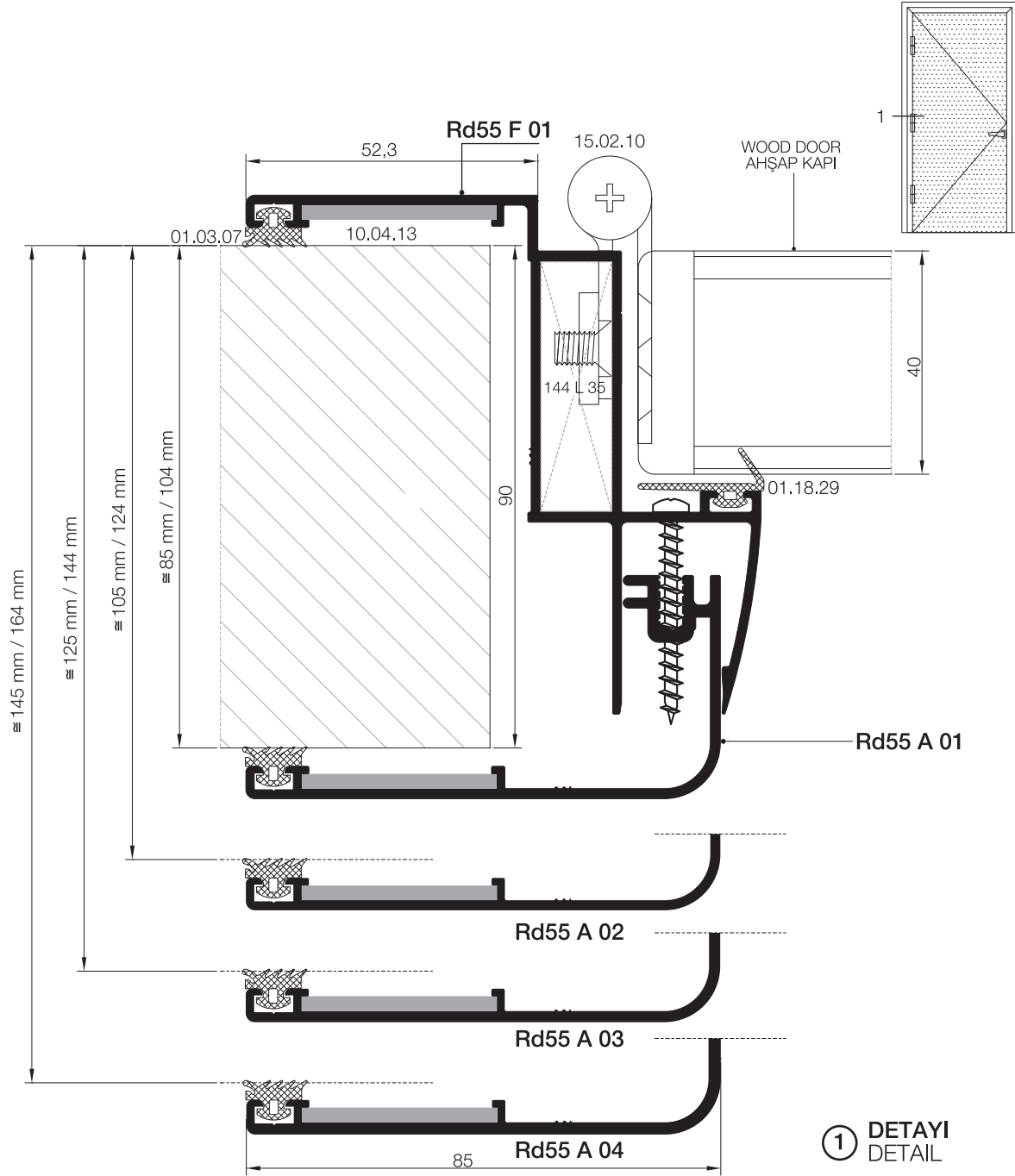

① DETAYI  
DETAIL

DUVAR KALINLIĞI WALL THICKNESS	KASA PROFİLİ FRAME PROFILE	PERVAZ PROFİLİ SILL PROFILE	ADAPTÖR PROFİLİ ADAPTER PROFILE
85 mm ~ 104 mm	Rd55 F 01 +	Rd55 A 01 +	-----
105 mm ~ 124 mm	Rd55 F 01 +	Rd55 A 02 +	-----
125 mm ~ 144 mm	Rd55 F 01 +	Rd55 A 03 +	-----
145 mm ~ 164 mm	Rd55 F 01 +	Rd55 A 04 +	-----

DUVAR KALINLIĞI WALL THICKNESS	KASA PROFİLİ FRAME PROFILE	PERVAZ PROFİLİ SILL PROFILE	ADAPTÖR PROFİLİ ADAPTER PROFILE
165 mm ~ 184 mm	Rd55 F 01 +	Rd55 A 01 +	Rd55 A 05
185 mm ~ 204 mm	Rd55 F 01 +	Rd55 A 02 +	Rd55 A 05
205 mm ~ 224 mm	Rd55 F 01 +	Rd55 A 03 +	Rd55 A 05
225 mm ~ 244 mm	Rd55 F 01 +	Rd55 A 04 +	Rd55 A 05

- 01
- 02
- 03
- 04
- 05
- 06
- 07
- 08
- 09
- 10

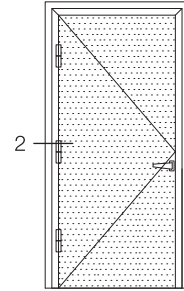
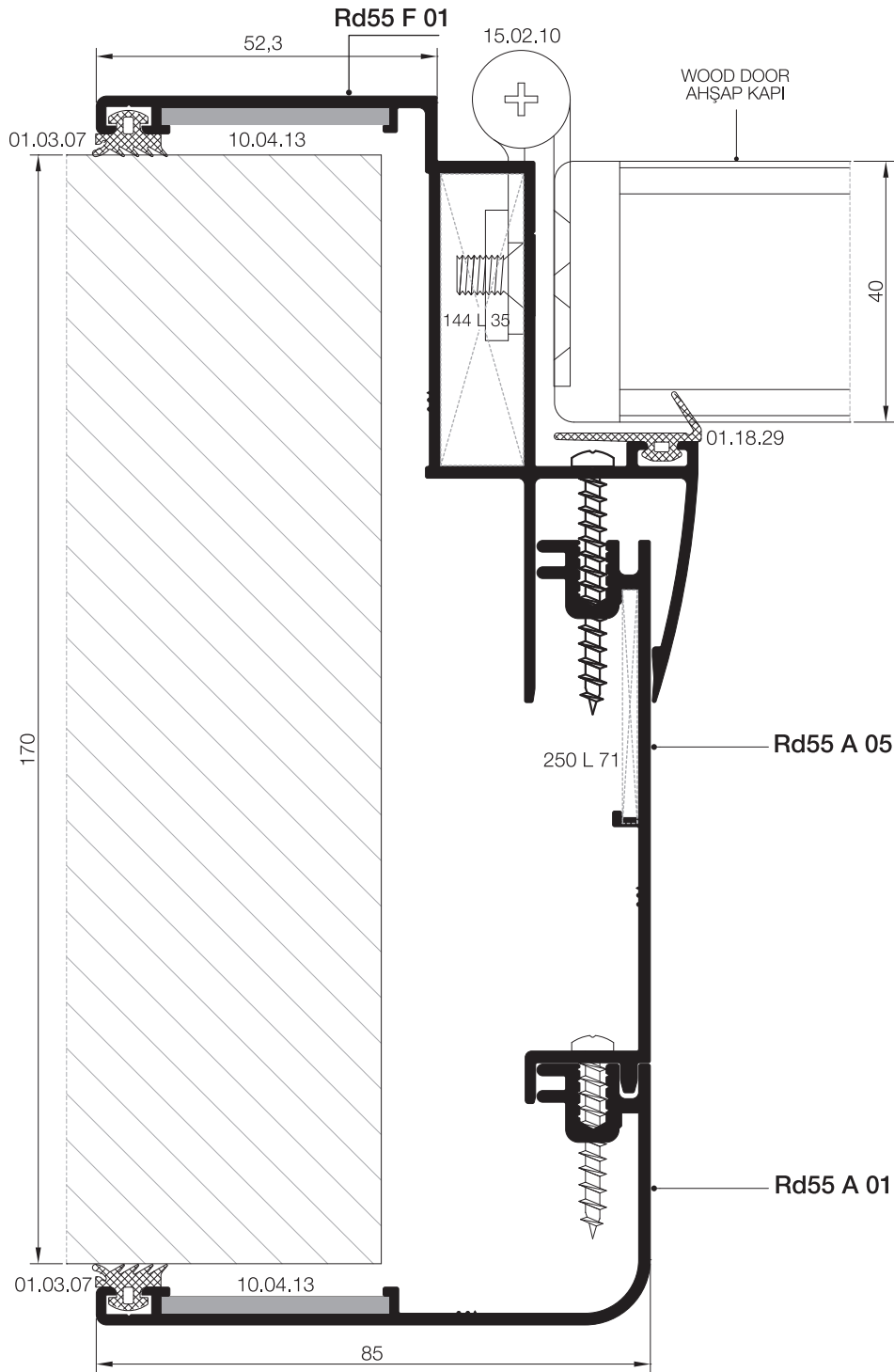

② DETAYI  
DETAIL

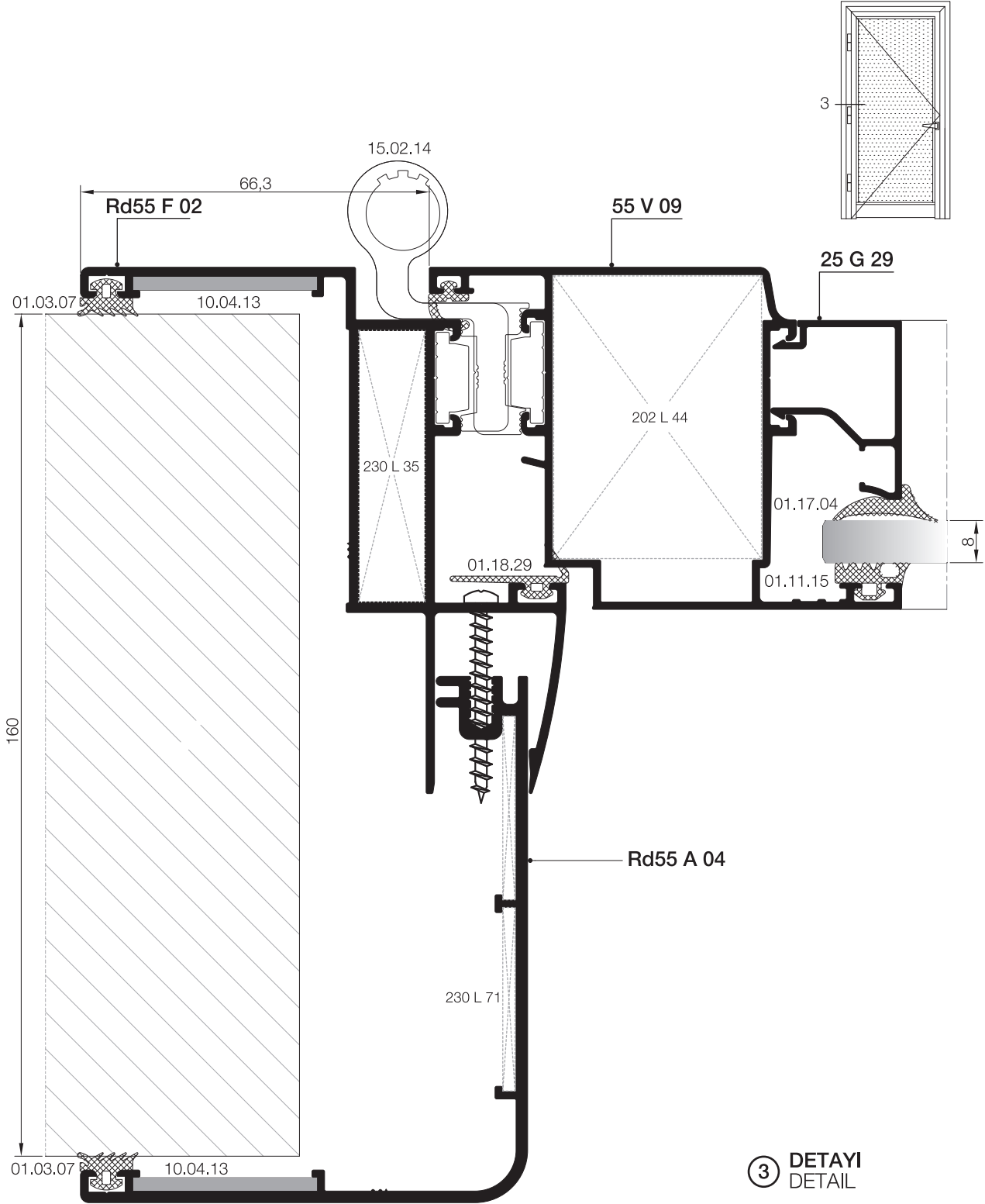

③ DETAYI  
DETAIL

DUVAR KALINLIĞI WALL THICKNESS	KASA PROFİLİ FRAME PROFILE	PERVAZ PROFİLİ SILL PROFILE	ADAPTÖR PROFİLİ ADAPTER PROFILE
90 mm ~ 109 mm	Rd55 F 02 +	Rd55 A 01 +	----
110 mm ~ 129 mm	Rd55 F 02 +	Rd55 A 02 +	----
130 mm ~ 149 mm	Rd55 F 02 +	Rd55 A 03 +	----
150 mm ~ 169 mm	Rd55 F 02 +	Rd55 A 04 +	----

DUVAR KALINLIĞI WALL THICKNESS	KASA PROFİLİ FRAME PROFILE	PERVAZ PROFİLİ SILL PROFILE	ADAPTÖR PROFİLİ ADAPTER PROFILE
170 mm ~ 185 mm	Rd55 F 02 +	Rd55 A 01 +	Rd55 A 05
189 mm ~ 209 mm	Rd55 F 02 +	Rd55 A 02 +	Rd55 A 05
210 mm ~ 229 mm	Rd55 F 02 +	Rd55 A 03 +	Rd55 A 05
230 mm ~ 249 mm	Rd55 F 02 +	Rd55 A 04 +	Rd55 A 05

- 01
- 02
- 03
- 04
- 05
- 06
- 07
- 08
- 09
- 10

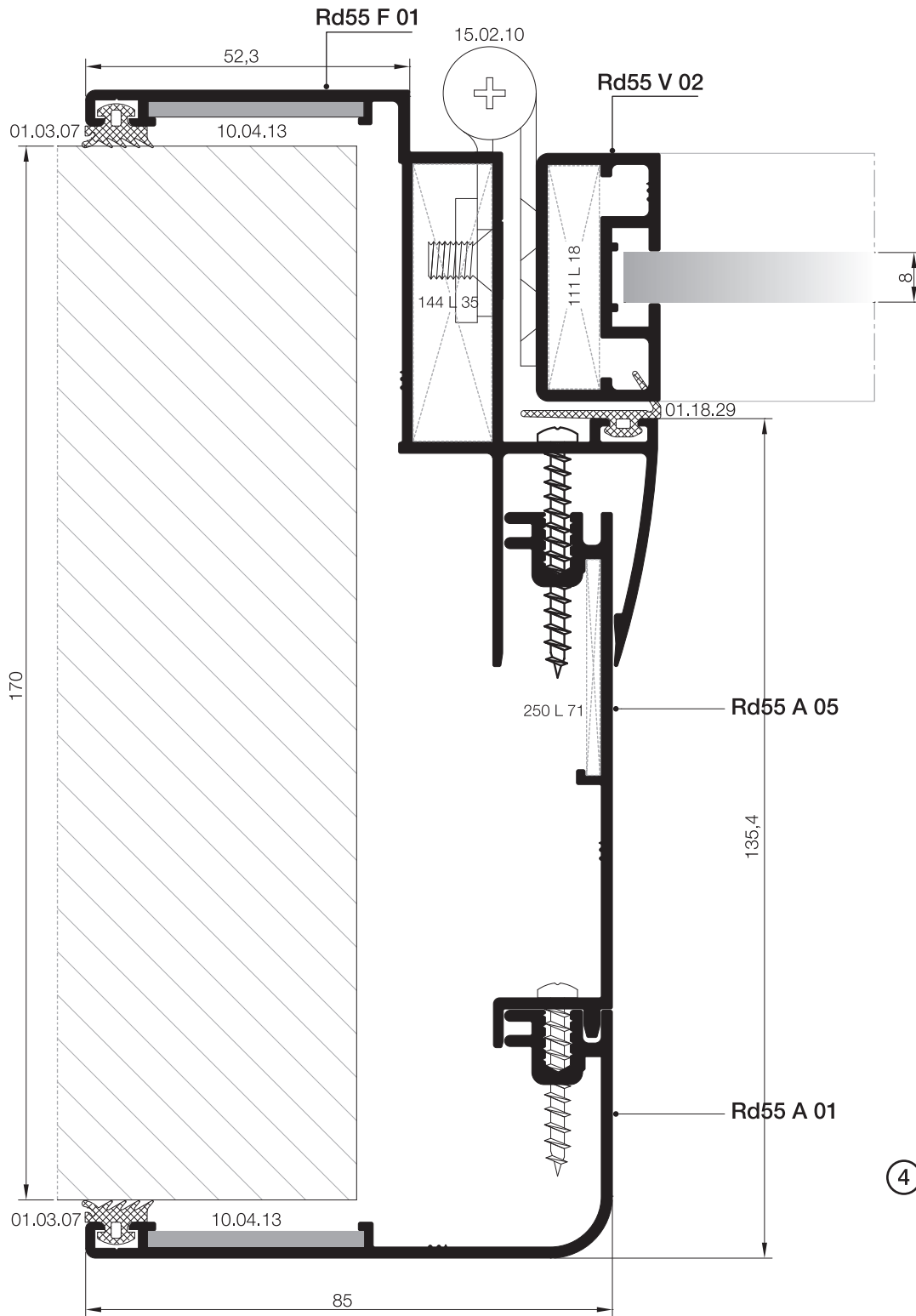

④ DETAYI  
DETAIL

# MİMARİ KATALOG ARCHITECTURAL CATALOGUE

Alüminyum Kapı Pencere ve Giydirme Cephe Sistemleri  
Aluminium Window Doors and Facade Systems



Rescara Sistem Detayları  
Rescara System Details

# Rd55

AKSESUARLAR

ACCESSORIES

01

02

03

04

05

06

07







08

09

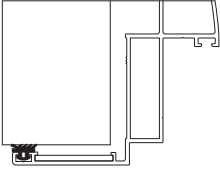
10

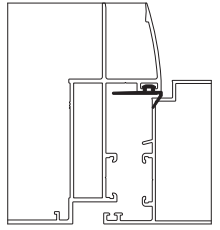
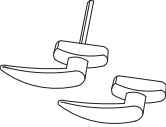
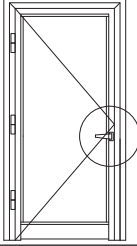
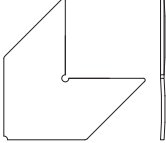
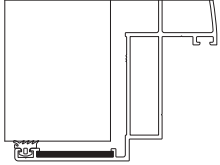

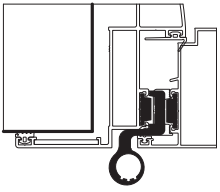
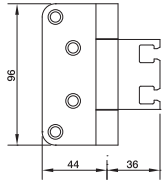
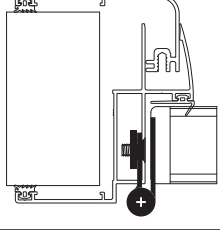

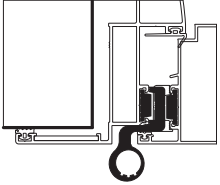
	<p>01.03.07 BİNİ FITİLİ ACCOUSTICAL GASKET</p> <p>Malzeme / Material : EPDM Ağırlık / Weight : 55 gr/m Paket / Package : 270 m / 15 kg</p>				
	<p>01.18.29 BİNİ FITİLİ ACCOUSTICAL GASKET</p> <p>Malzeme / Material : EPDM Ağırlık / Weight : 75 gr/m Paket / Package : 200 m / 15 kg</p>				
	<p>07.14.04 KAPI KOLU DOOR HANDLE</p> <p>Malzeme / Material : - Renk: Siyah-Beyaz-Gri Color: Black-White-Grey</p>				
	<p>10.04.13 KÖŞE ÇAVUŞU CORNER PIECE</p> <p>Malzeme : Paslanmaz Çelik Material : Stainless Steel</p>				
	<p>15.02.09 YERLİ KAPI MENTEŞESİ LOCAL HINGE DOORS</p> <p>Renk: Siyah-Beyaz-Gri-Eloksal Color: Black-White-Grey-Anodised 85 kg için 3 adet kullanılmalıdır. Should be used 3 for 85 kg. Max. kanat ölçüsü 900 x 2200 Max. vent dimension 900 x 2200</p>	<p>55 V 09</p> 			
	<p>15.02.10 KAPI MENTEŞESİ DOOR HINGE</p> <p>Renk: Siyah-Beyaz-Gri-Eloksal Color: Black-White-Grey-Anodised</p>				
	<p>15.02.14 GIESSE KAPI MENTEŞESİ GIESSE HINGE FOR DOORS</p> <p>Renk: Siyah-Beyaz-Gri-Eloksal Color: Black-White-Grey-Anodised 100 kg için 2 adet 120 kg için 3 adet kullanılmalıdır. / Should be used 2 for 100 kg, 3 for 120 kg. EN 1935</p>	<p>55 V 09</p> 			

01

02

03

04

05

06

07

08

09

10

